

# DOOR LOCKS

## Installation Guide

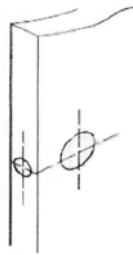

1.- Make a hole of 1" diameter by 3" ¼ of depth to the edge of the door and the view make a hole with a diameter of 2" 1/8 with a Center 2" 3/8 from the edge of the door.

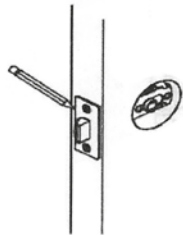

2.- Place the latch and mark the outline of the same to the door, remove the latch.

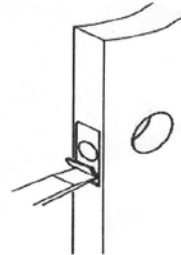

3.- Make a recess according to the earlier trade mark made of mind, with a depth of 1/8"

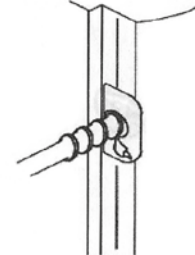

4.- Placed strikes plane the frame and mark the center hole, subsequently cut before marked with a 1" deep.

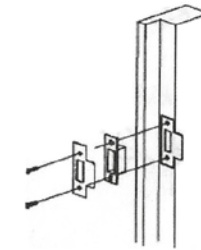

5.- Placed strikes plane the frame and fix with screws.

6.- Latch is adjustable from 2" 3/8 or 2" 3/4, in case of using the second measurement, in step 1 change the measure (2" 3/8) from the center of side hole for the of 2" 3/4.

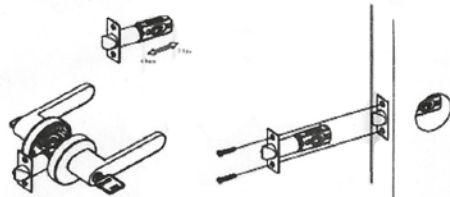

7.- Place the latch to the door and install the screws to secure the same.

### Inner Handle

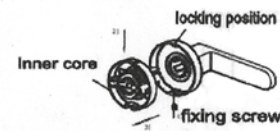

8.- A) Remove the fixing screw.  
B) Move inner bottom down  
C) Remove the interior of the position for fixing base

### Inner core for inner handle



9.- Already having placed on the door latch, fasten with the screws the outside handle along with the inner core of the inside handle

### Outer handle

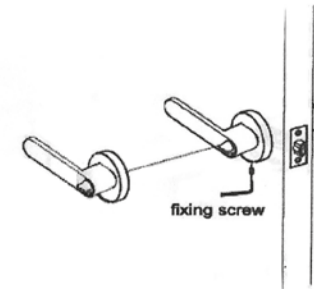
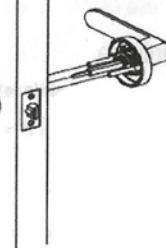

10.- Join the inside handle on the internal rosette and fixing screw

### Reversible handle

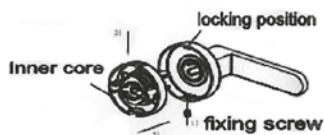

8.- A) Remove the fixing screw.  
B) Move inner bottom down  
C) Remove the interior of the position for fixing base



8A.- After removing handle rotate 180° and install again in the rosette, this is when you reach step 10 installation